

ARMATURA DI BASE SUPERIORE PIASTRA 1 QUOTA m.0.00
 Ø 16/ 20 direz.X
 Ø 16/ 20 direz.Y (spessore= 30 cm)
 ACCIAIO B450C CALCESTR. C25/30

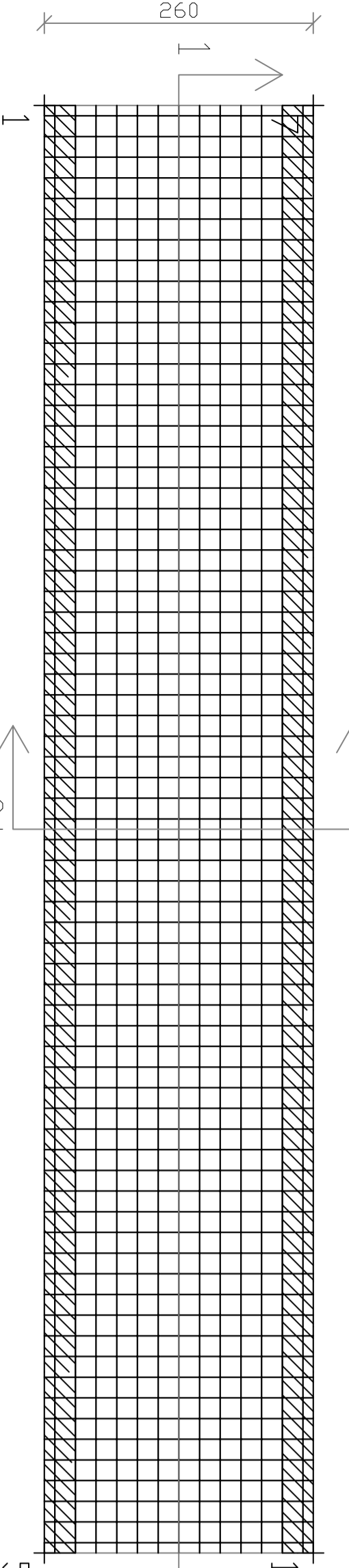

ARMATURA DI BASE INFERIORE PIASTRA 1 QUOTA m.0.00
 Ø 16/ 20 direz.X
 Ø 16/ 20 direz.Y (spessore= 30 cm)
 ACCIAIO B450C CALCESTR. C25/30

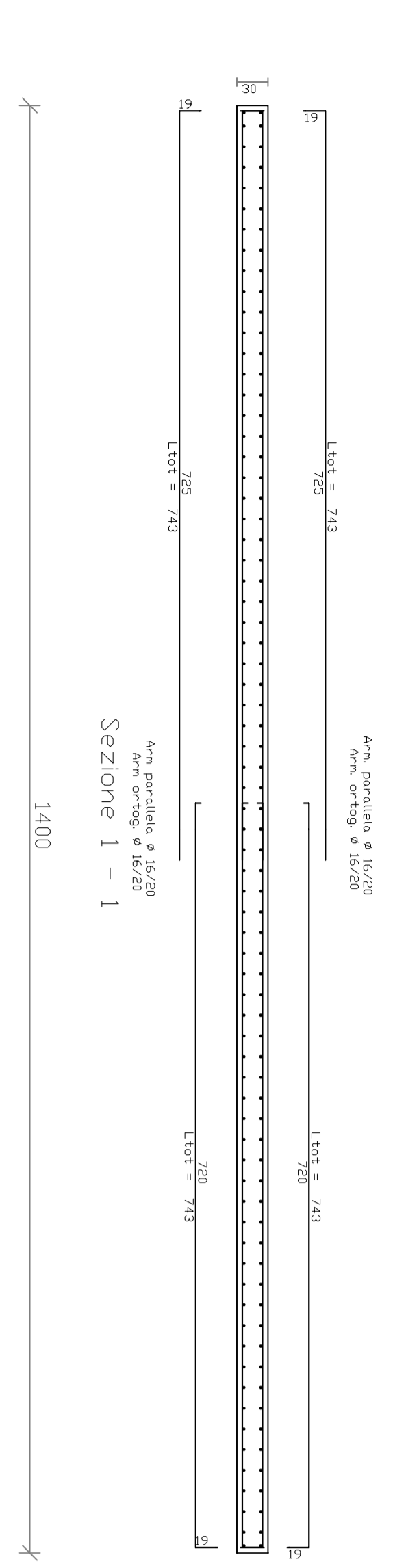
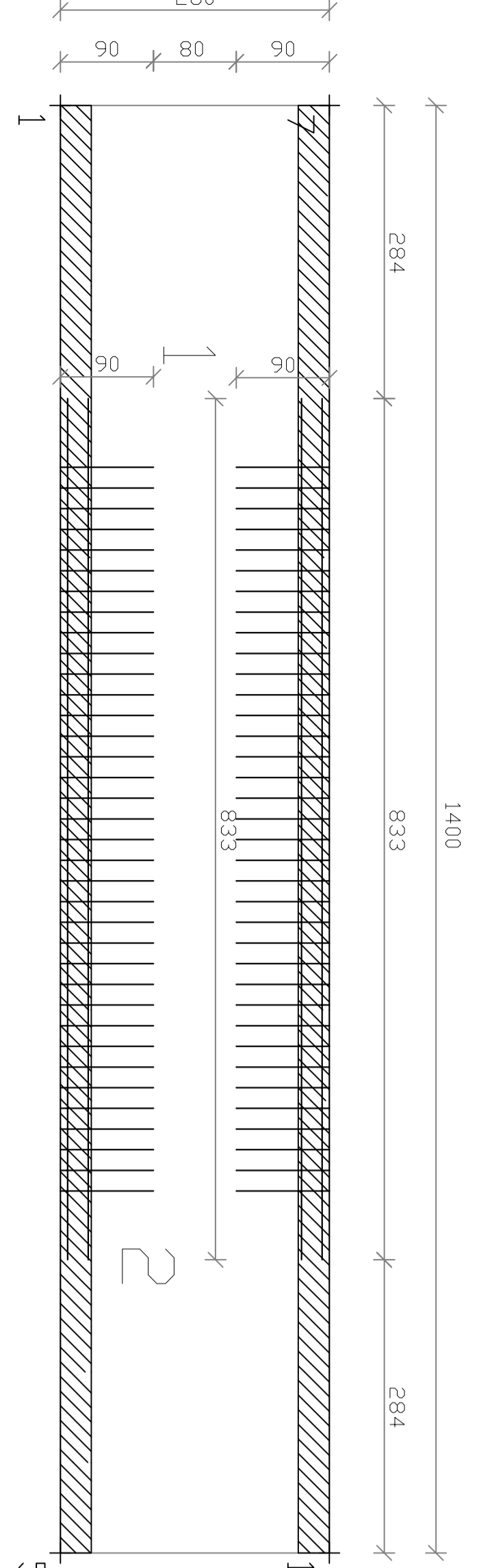

PIASTRA 1 QUOTA m. 0.00
 TABELLA RAFFITTIMENTI INF.

DIR X	DIR Y	L.X	L.Y
Ø16/20	Ø16/20	833	90
Ø16/20	Ø16/20	833	90
Ø16/20	Ø16/20	833	90

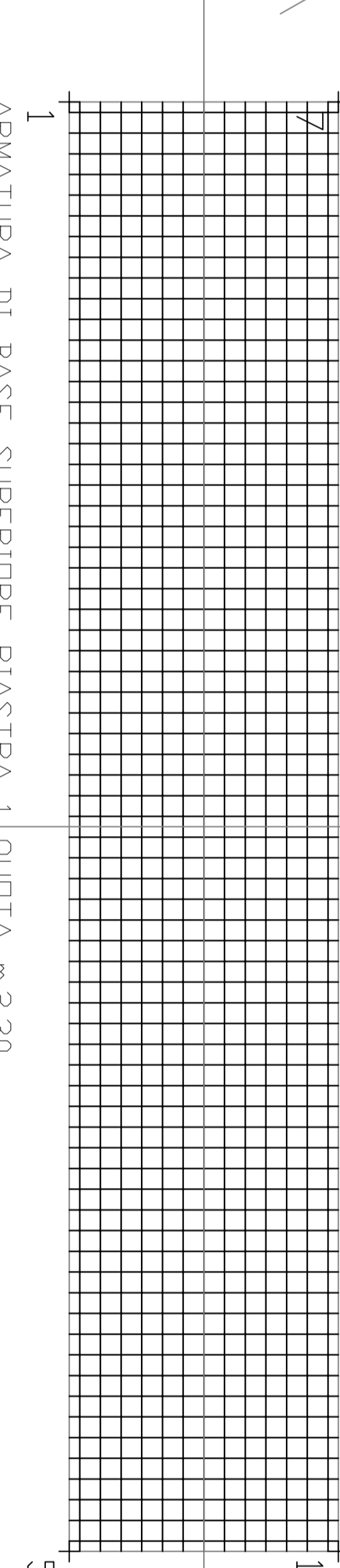
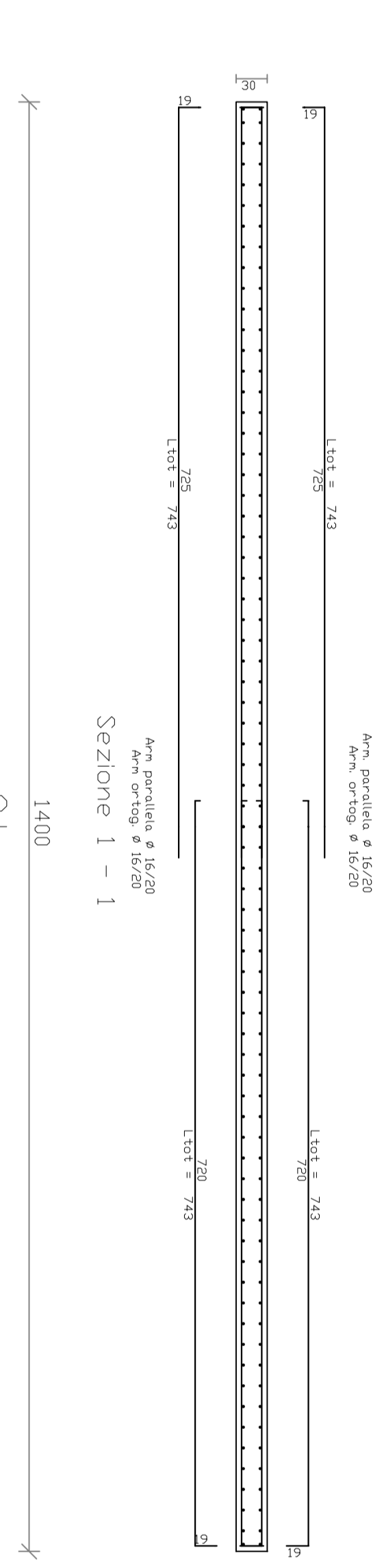
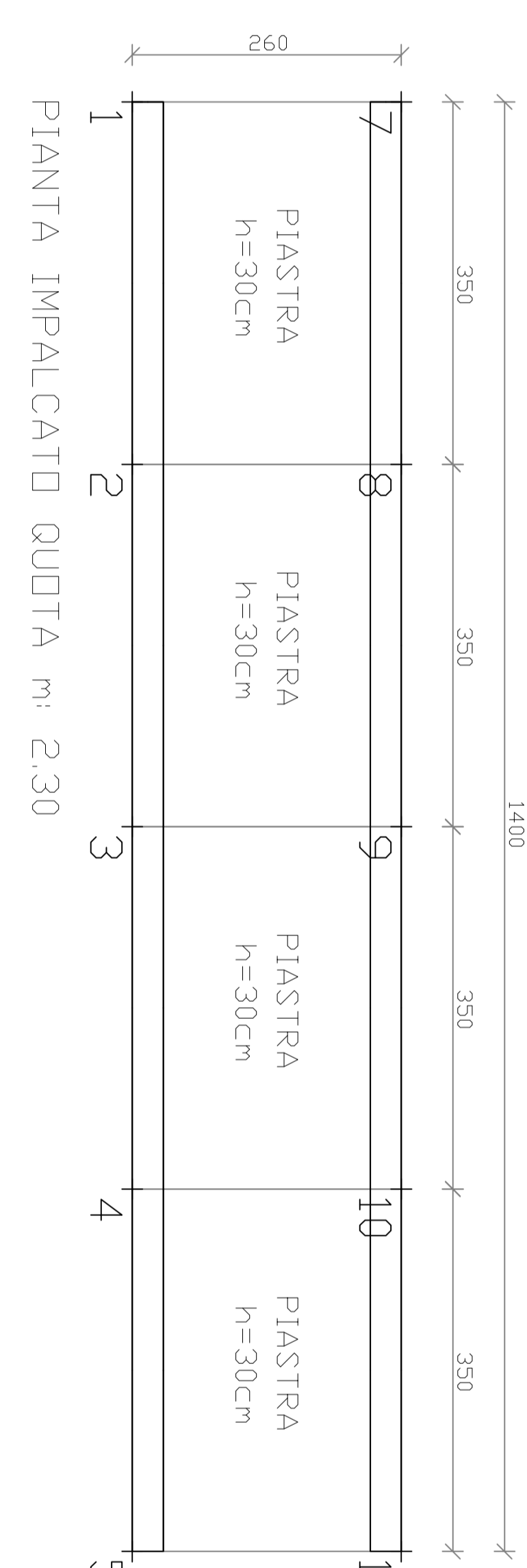

ARMATURA DI BASE SUPERIORE PIASTRA 1 QUOTA m.2.30
 Ø 16/ 20 direz.X
 Ø 16/ 20 direz.Y (spessore= 30 cm)
 ACCIAIO B450C CALCESTR. C25/30

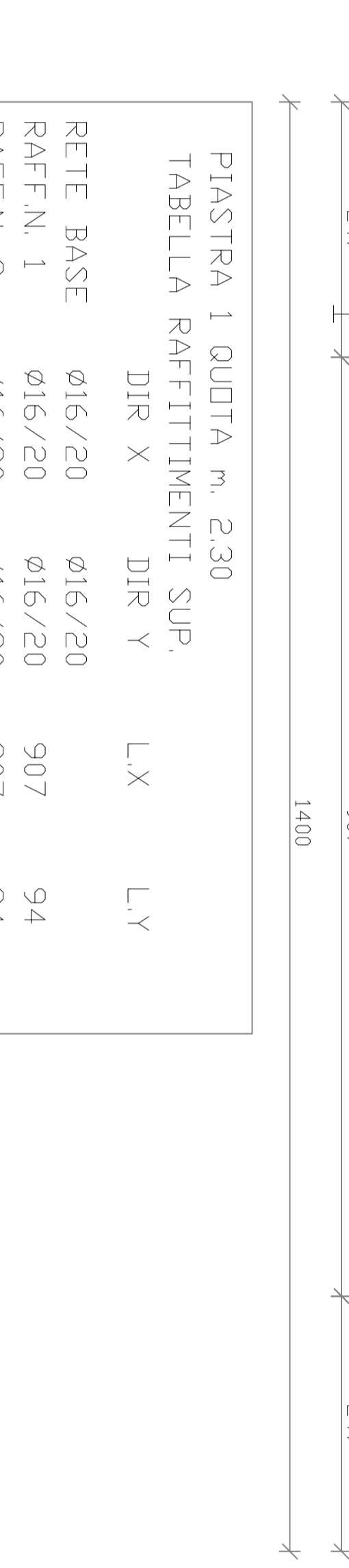
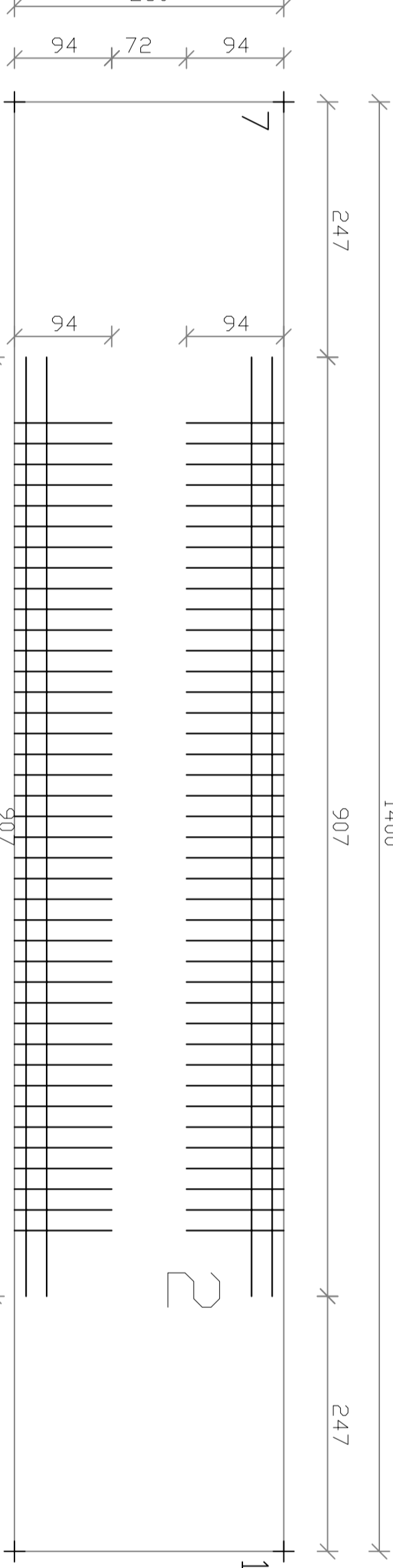

PIASTRA 1 QUOTA m. 2.30
 TABELLA RAFFITTIMENTI SUP.
 DIR X DIR Y L.X L.Y

Ø16/20	Ø16/20	907	94
Ø16/20	Ø16/20	907	94
Ø16/20	Ø16/20	907	94

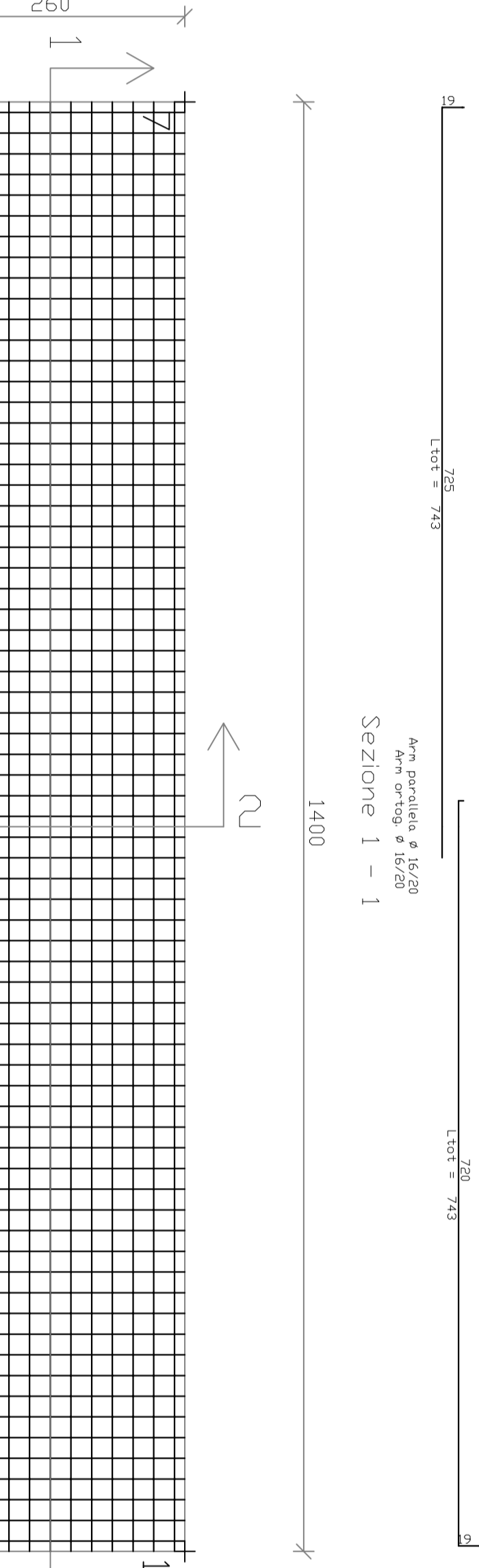

ARMATURA DI BASE INFERIORE PIASTRA 1 QUOTA m.2.30
 Ø 16/ 20 direz.X
 Ø 16/ 20 direz.Y (spessore= 30 cm)
 ACCIAIO B450C CALCESTR. C25/30

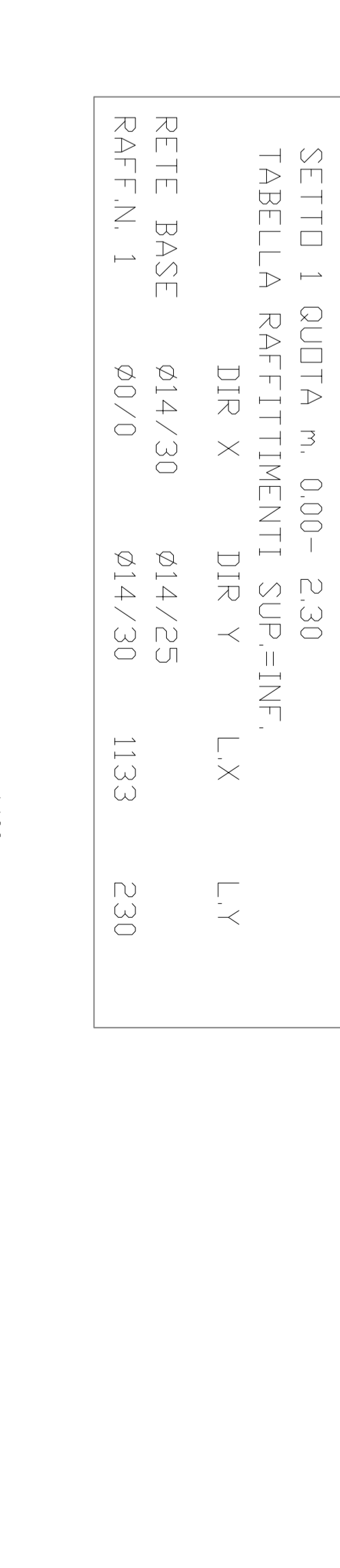
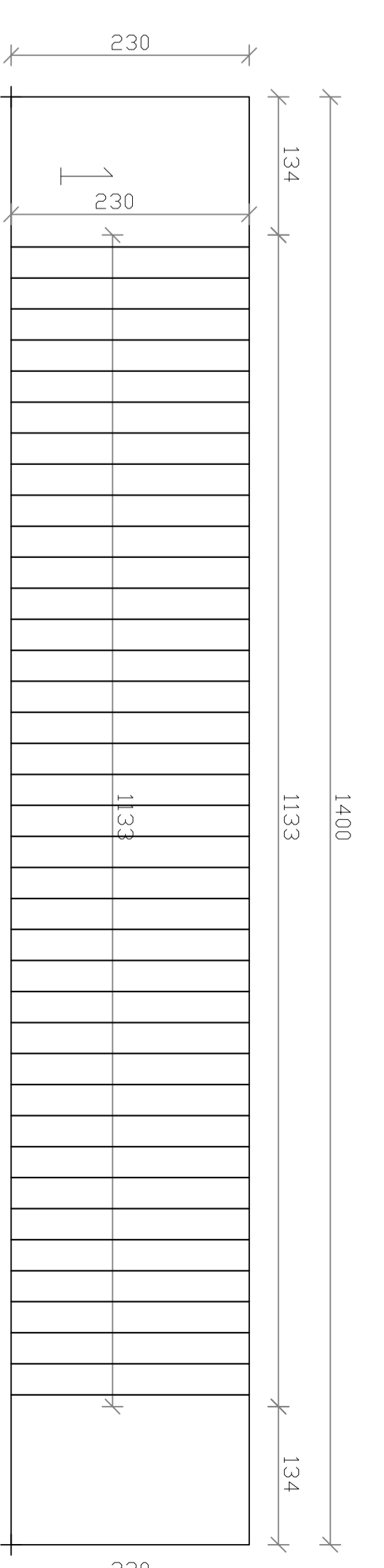
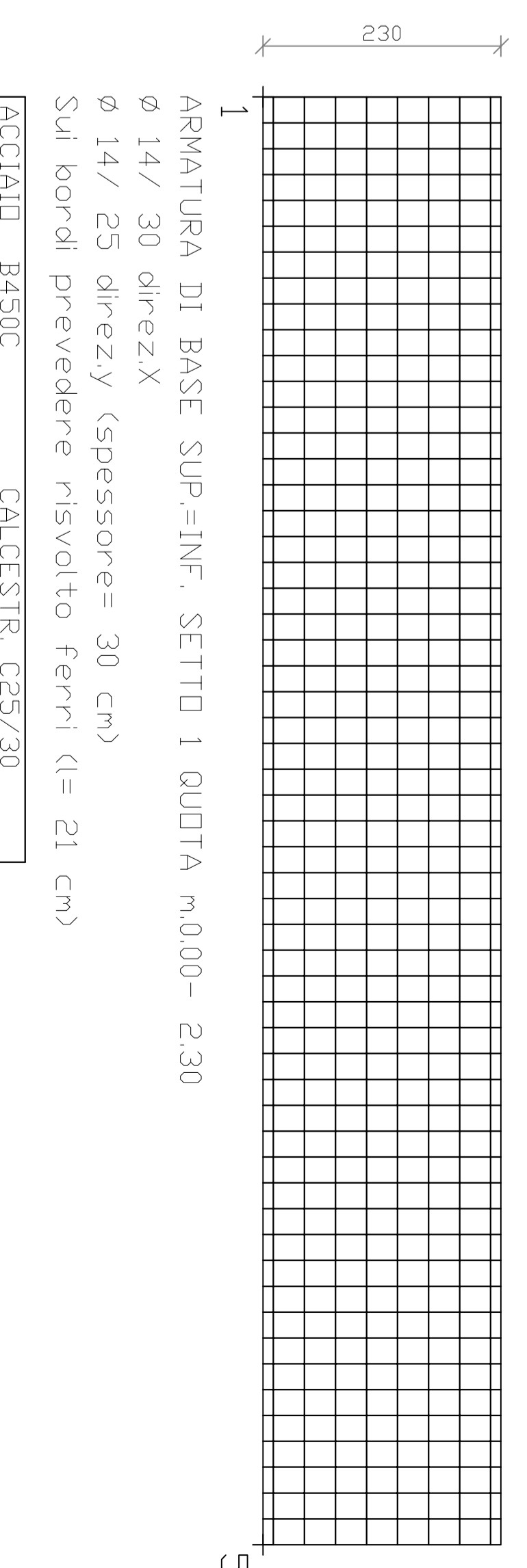

SETTO 1 QUOTA m. 0.00- 2.30
 TABELLA RAFFITTIMENTI SUP=INF.
 DIR X DIR Y L.X L.Y

Ø14/30	Ø14/25	1133	230
Ø0/0	Ø14/30	1133	230

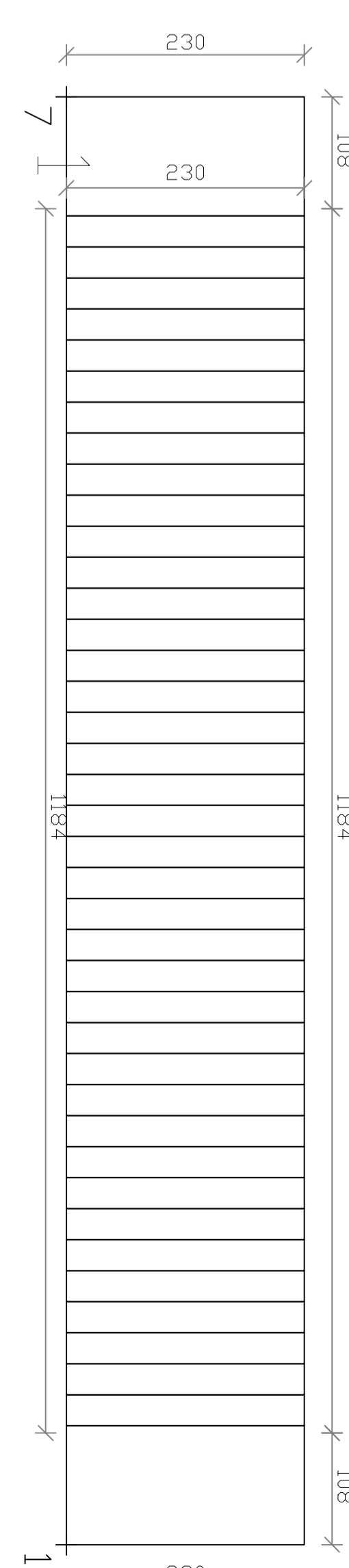
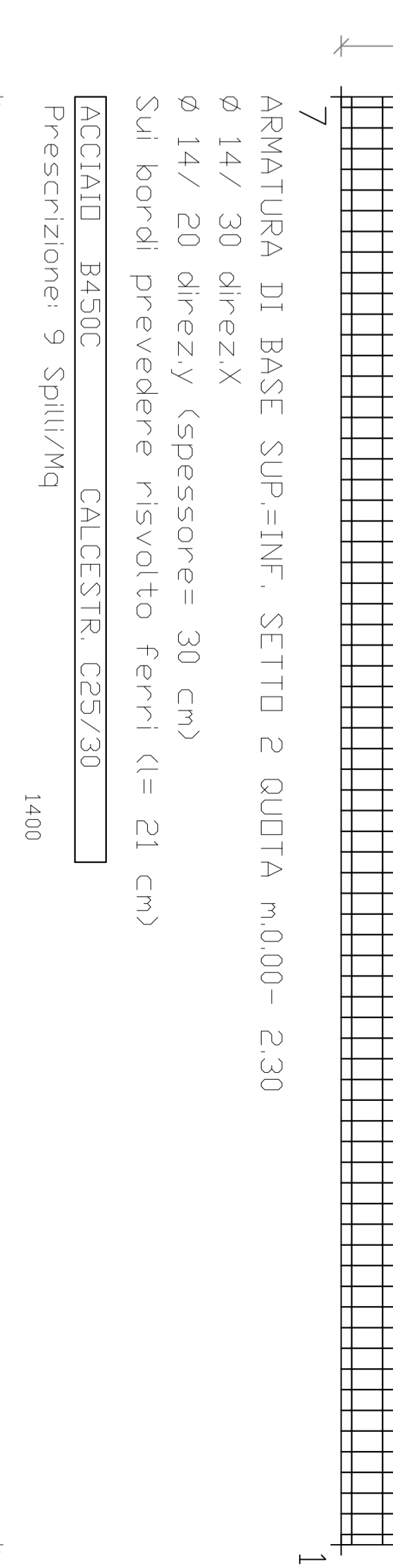

SETTO 2 QUOTA m. 0.00- 2.30
 TABELLA RAFFITTIMENTI SUP=INF.
 DIR X DIR Y L.X L.Y

Ø14/30	Ø14/20	1184	230
Ø0/0	Ø14/30	1184	230



TRAPUOLA TORBINO 200 x 200

DIMENSIONI		CARATTERISTICHE	
A	200 m	SONDO	11,10 mc/m
H	200 m	CASSERONE	18,80 mc/m
S	0,30 m	CAMERIERIA	37,15 mc/m
S1	0,30 m	CLS IN FONDAZIONE	0,78 mc/m
S2	0,30 m	CLS IN ELEVAZIONE	1,98 mc/m
Smpr	0,10 m	MADONNE	0,30 mc/m

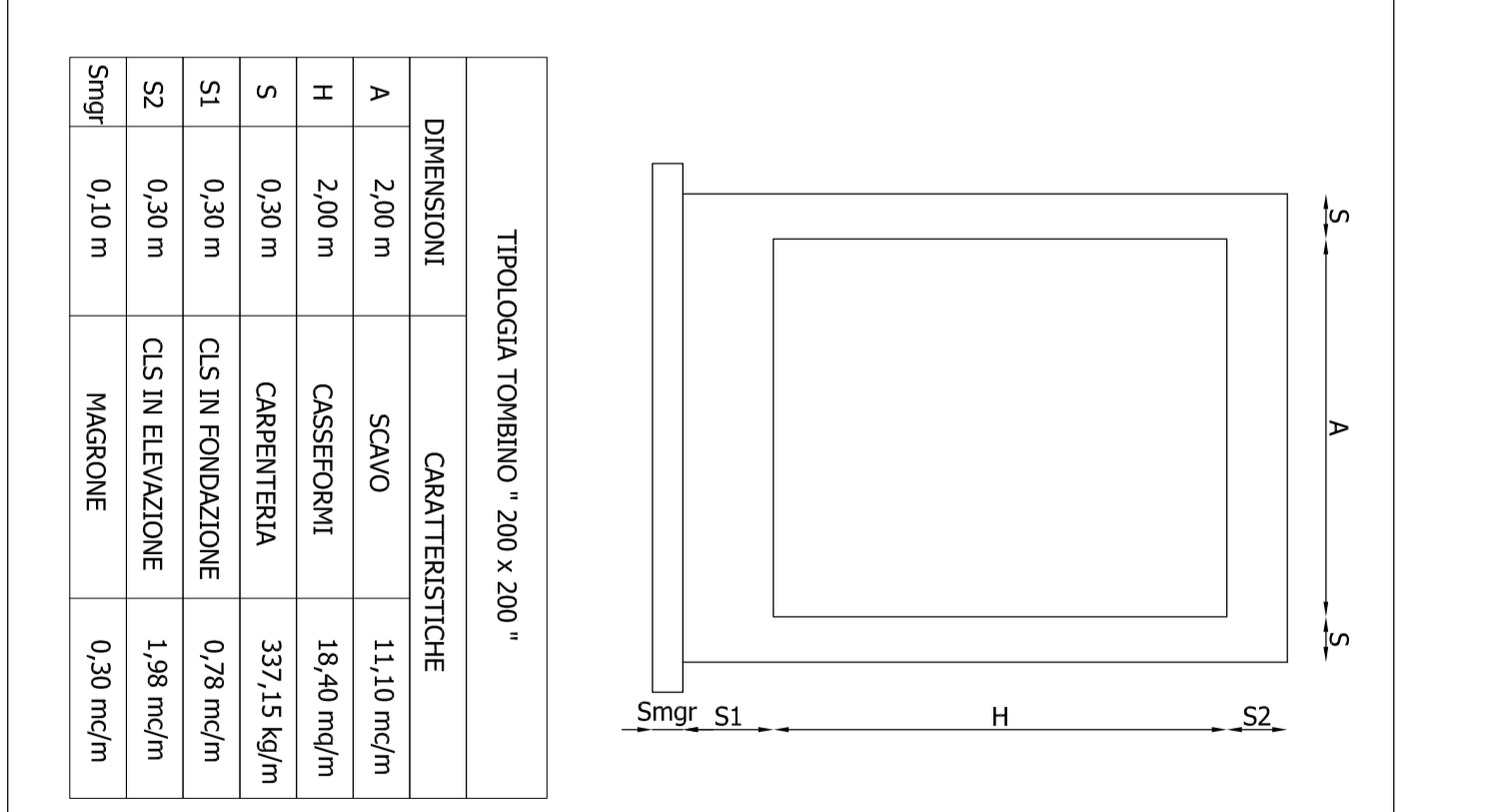

Provincia Regionale di Ragusa
 Ammodernamento del tracciato stradale
 S.P. n. 46 ISPICA - POZZALLO
 1° STRALCIO FUNZIONALE

Responsabile Ufficio Progettazione
Dott. Ing. Salvatore Diwanzola

Direttore Funzionaria del Tribunale
Dott. Ing. Vincenzo Cappelletti

PROGETTO ESECUTIVO

OGGETTO: OFFERTE D'ARTE MINORI
 • TOMBINI IDEALUCI
 • TOMBINO 2.00x2.00 CARPENTIERE ED ARMATURE

SCALA: 1:50
 ELABORATO: 7.2.4

GRUPPO DI PROIEZIONE
IR - INGEGNERIA
 STUDIO TECNICO ASSOCIATO
IUDICE STUDIO IUDICE S.r.l.

RESPONSABILE DELLE INTERAZIONI
 Dott. Ing. M. Baccata

RESPONSABILE DI PROGETTO
 Dott. Ing. M. Baccata
 Dott. Ing. G. Fella
 Dott. Ing. F. Inda

1. STUDIO DELLA PROPOSTA E SCHEMI PRELIMINARI	2. PROGETTO PRELIMINARE	3. PROGETTO ESECUTIVO	4. VERIFICA
5. APPROVAZIONE	6. APPROVAZIONE	7. APPROVAZIONE	8. APPROVAZIONE
9. APPROVAZIONE	10. APPROVAZIONE	11. APPROVAZIONE	12. APPROVAZIONE